



April 16th, 2012

Collegewide Masterplanning

St. Petersburg/Gibbs Campus





- + Campus Location
- + Front Door
- + Pedestrian Access
- + Vehicular Access
- + Parking Information
- + Site Analysis
- + Master Plan
- + Material Palette
- + Outdoor Student Gathering Spaces
- + Signage
- + Conclusion



Views of the James E. Hendry Administration Building from Intersection of 66th Street North & 5th Avenue North



Front Door

East Entrance at 66th Street North



Collegewide Masterplanning St. Petersburg/Gibbs Campus

Front Door

Entrance at 5th Avenue North



Collegewide Masterplanning **St. Petersburg/Gibbs Campus**

Front Door

West St. Petersburg Community Library Entrance at 8th Avenue North



Front Door

New Signage at 5th Avenue North



Pedestrian Access

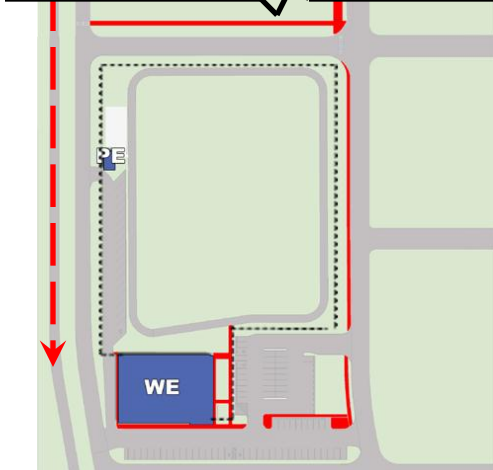
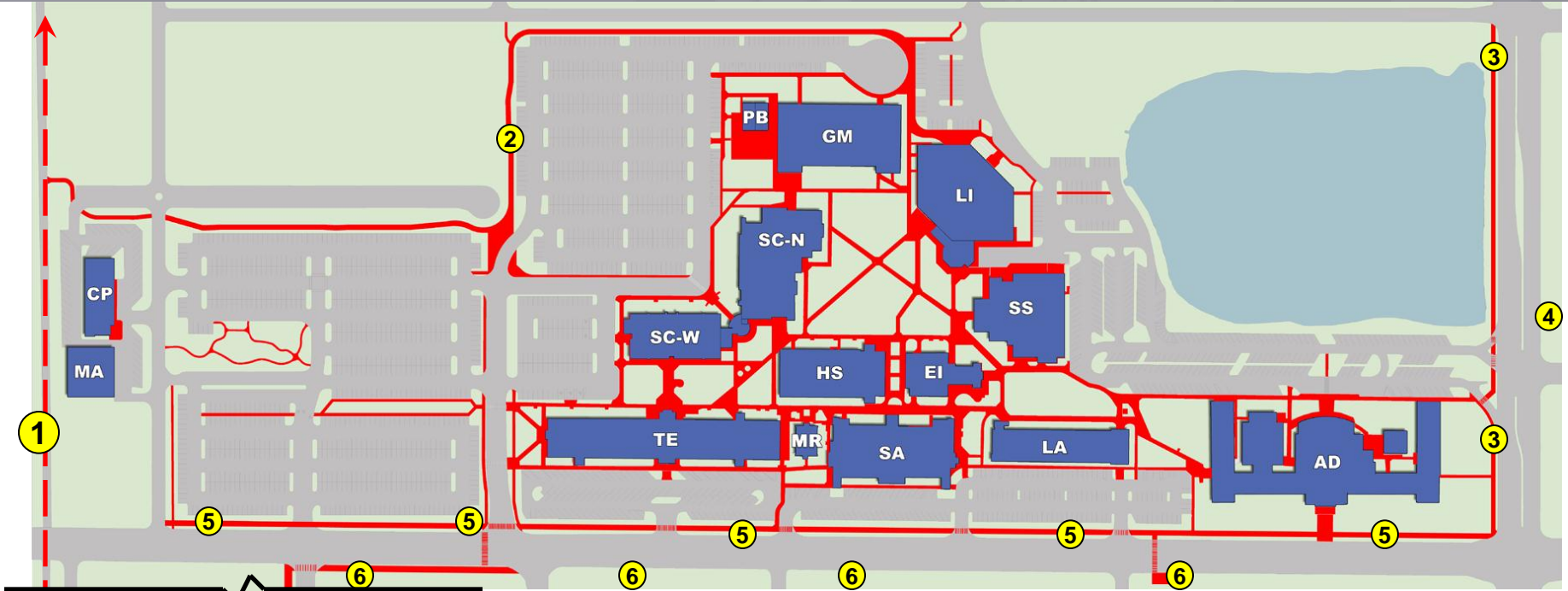

- 1. Pinellas Trail
- 2. Access to Pinellas Trail
- 3. PSTA Bus Stop – 79 Williams Park
- 4. PSTA Bus Stop – 79 US 19
- 5. PSTA Bus Stop – 5 Tyrone Mall
- 6. PSTA Bus Stop – 5 Williams Park

 Sidewalks



Vehicular Access

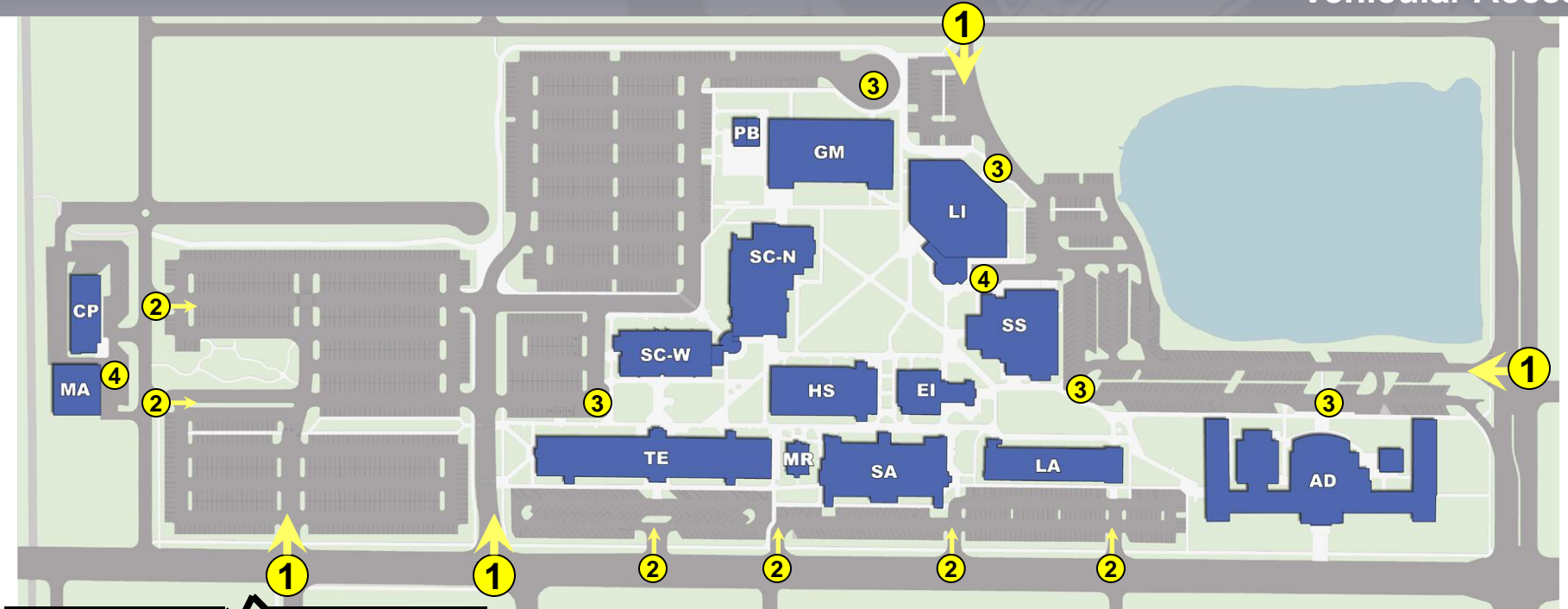

- 1. Primary Access
- 2. Secondary Access
- 3. Drop Off Locations
- 4. Service / Receiving Locations



Parking Information

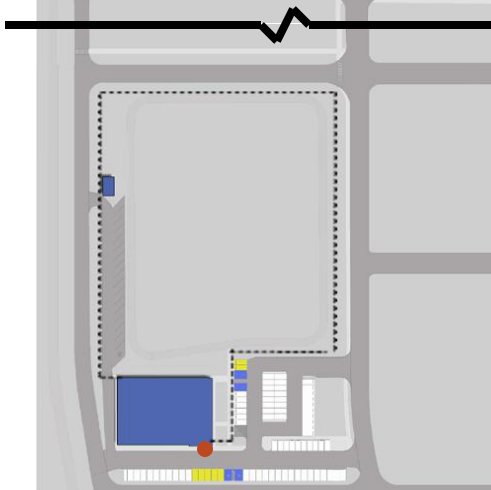

Color	Designation	# of Spaces Main Campus	# of Spaces Wellness Site
Yellow	Staff ¹	170	7
Green	Student	1489	68
Blue	Visitor	110	0
Light Blue	Handicapped ²	53	4
Purple	HOV	4	0
Dark Purple	Hybrid	4	0
Orange	Motorcycle	31	0
Red	Bicycle	9 racks	1 rack

1. The count does not include parking at Chiller Plant for Facilities Services Staff & Vehicles.

2. The count exceeds the amount of Handicapped Parking Spaces required.



Site Analysis

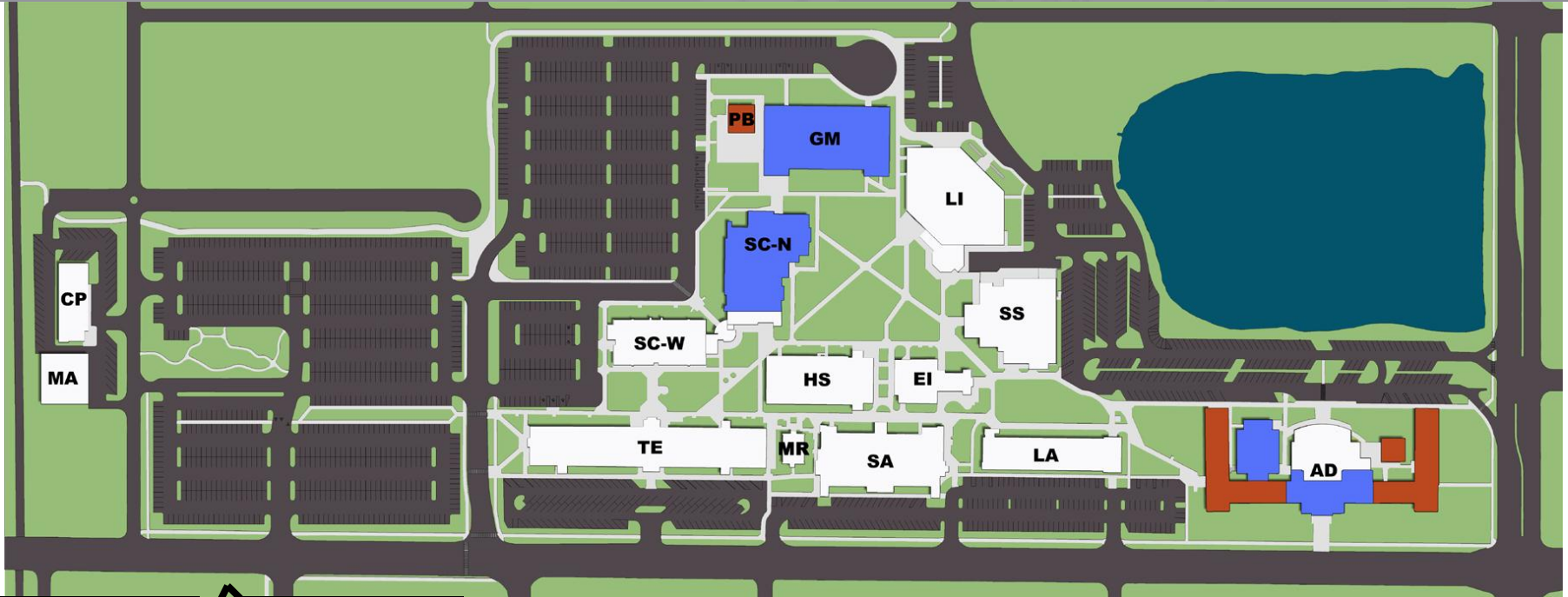

Color	Description	Buildings
	New or existing buildings to remain	MA, CP, TE, SC-W, HS MR, SA, EI, LI, SS, LA, MC
	Existing buildings In need of renovation and updating	AD-Original , GM, SC-N
	Existing buildings to be demolished	AD-East & West Wings, WE, PB, PE



Site Analysis - Square Footage Summary

Existing Buildings	Bldg ID	Year Built	Year(s) Renovate	Buildings to Remain (sf)	Buildings In Need Of Updating & Renovation (sf)	Buildings to Demo (sf)
AD – James E. Hendry Administration Building	1					
Original Administration		1941	n/a		11,951	
East & West Wing		1941	n/a			32,391
Campus Meeting Center		1990	n/a			1,460
Map Center		1990	n/a		6,751	
Music Center		1998	n/a	14,862		
LA – Language Arts	2	1957	1993	26,565		
SS – Student Services	3	2009	n/a	44,055		
HS – Humanities	4	1957	1994	15,655		
TE – W. Richard Johnston Technical Building	5	1960				
East Wing			1995	23,328		
West Wing			2002	28,500		
SC – Natural Science	6	2004				
North Wing			1988		41,099	
West Wing			2003	39,600		
GM – Gymnasium	7	1957	n/a		25,524	
LI – West St. Petersburg Community Library	8	2005	2002	54,320		
MA – Maintenance Building	10	2003	n/a	7,053		
SA – Philip Benjamin Social Arts Building	11	1963	1999	58,538		
WE – Wellness Center	13	1967	n/a			19,808
ET – Ethics Institute	14	1959	1994	13,514		
MR – Music Industry Recording Arts	16	1992	2010	2,382		
PE – Storage	17	1967	n/a			288
CH – Chiller Plant	20	1996	1996	7,587		
PB – Portable 119	119	1989	2004			852
SF Subtotal				335,959	85,325	54,799

Total Existing SF of Campus: 476,083

Master Plan - Existing Conditions

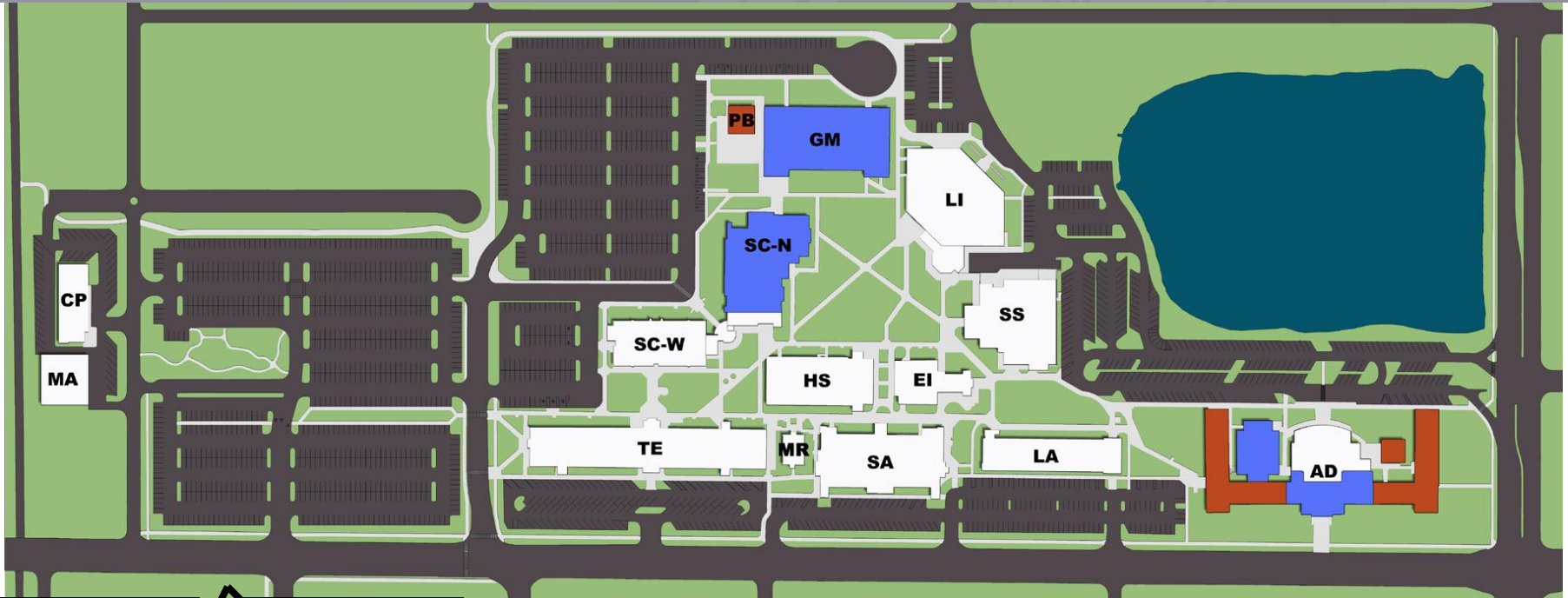

Color	Description
	New or Existing buildings to remain
	Existing buildings in need of renovation and updating
	Existing buildings to be demolished



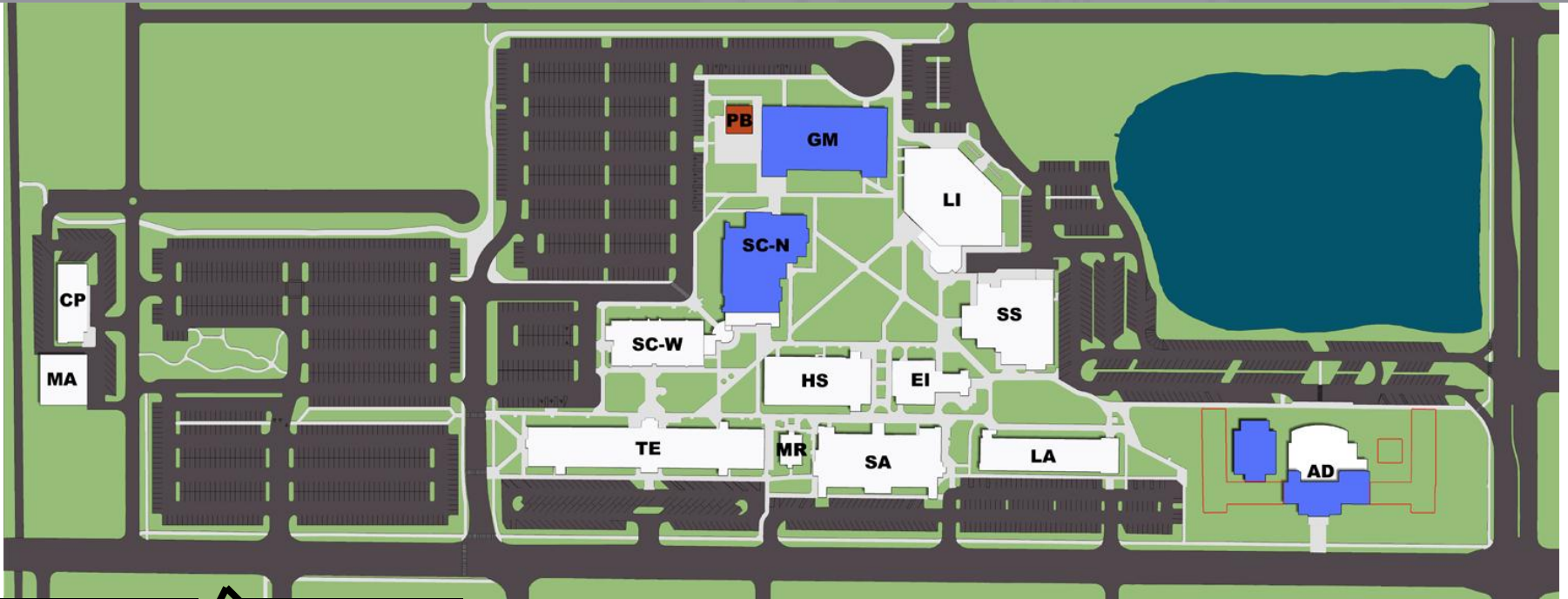

PHASE ONE

Item	Description
1	Selective Demolition of Administration (AD) Building
2	Remodel Existing Administration (AD) Building
3	Build New Student Support Services Building (50,000 gsf)



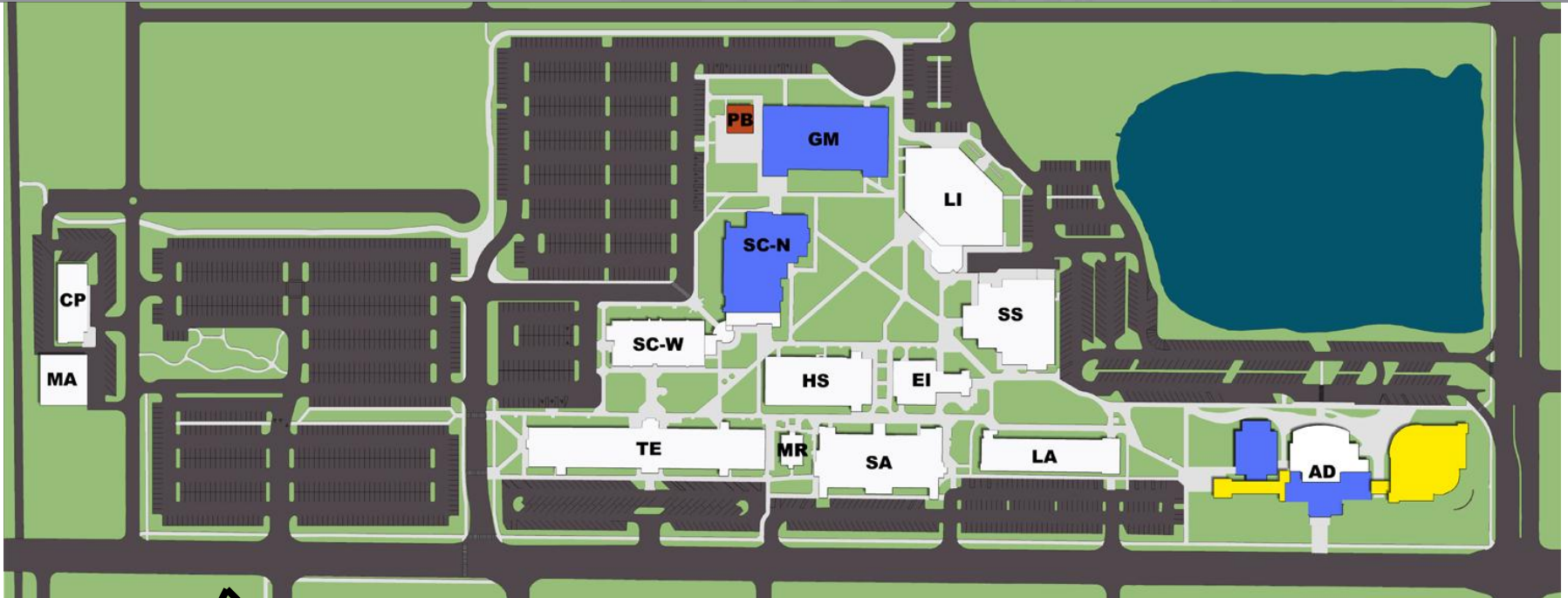

PHASE ONE

Item	Description
1	Selective Demolition of Administration (AD) Building
2	Remodel Existing Administration (AD) Building
3	Build New Student Support Services Building (50,000 gsf)



Master Plan – Phase 1

**Student Support Services Building
Design Study
View from 66th Street & 5th Avenue**



Master Plan – Phase 1

Student Support Services Building Design Study Concept Floor Plans

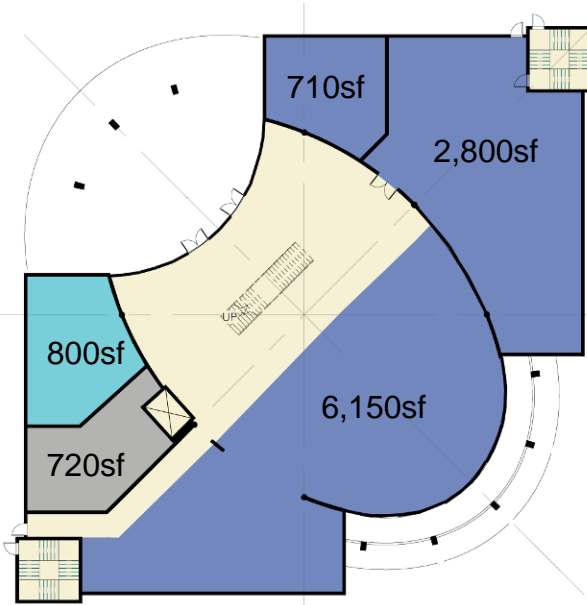

First Floor

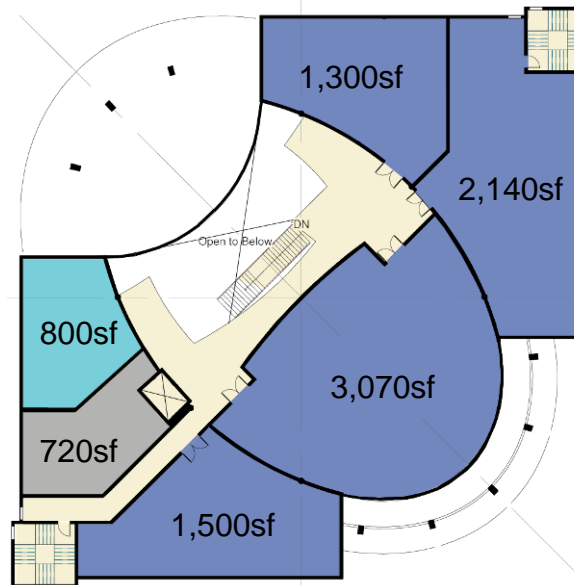

Second Floor

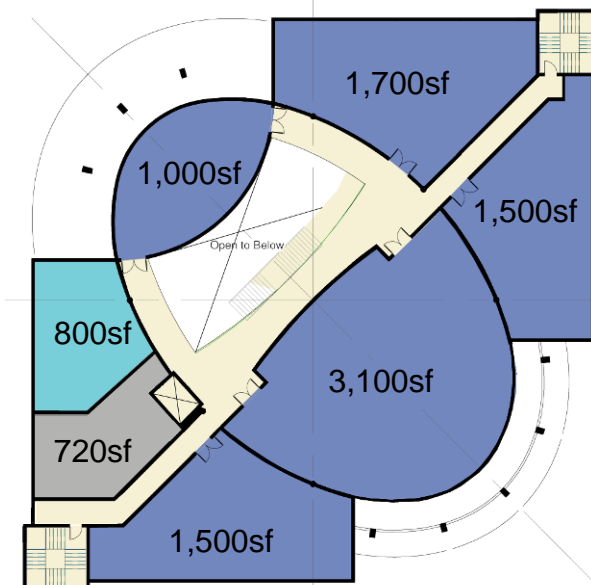

Third Floor

Master Plan – Phase 1

**Student Support Services Building
Design Study
View from Lake**



Master Plan – Phase 1

**Student Support Services Building
Design Study
New Pedestrian Plaza**



Collegewide Masterplanning St. Petersburg/Gibbs Campus

Master Plan – Phase 1

**Student Support Services Building
Design Study
Restoration of James E. Hendry Administration Building**



Master Plan – Phase 1

**Student Support Services Building
Design Study
Interior Concept View**



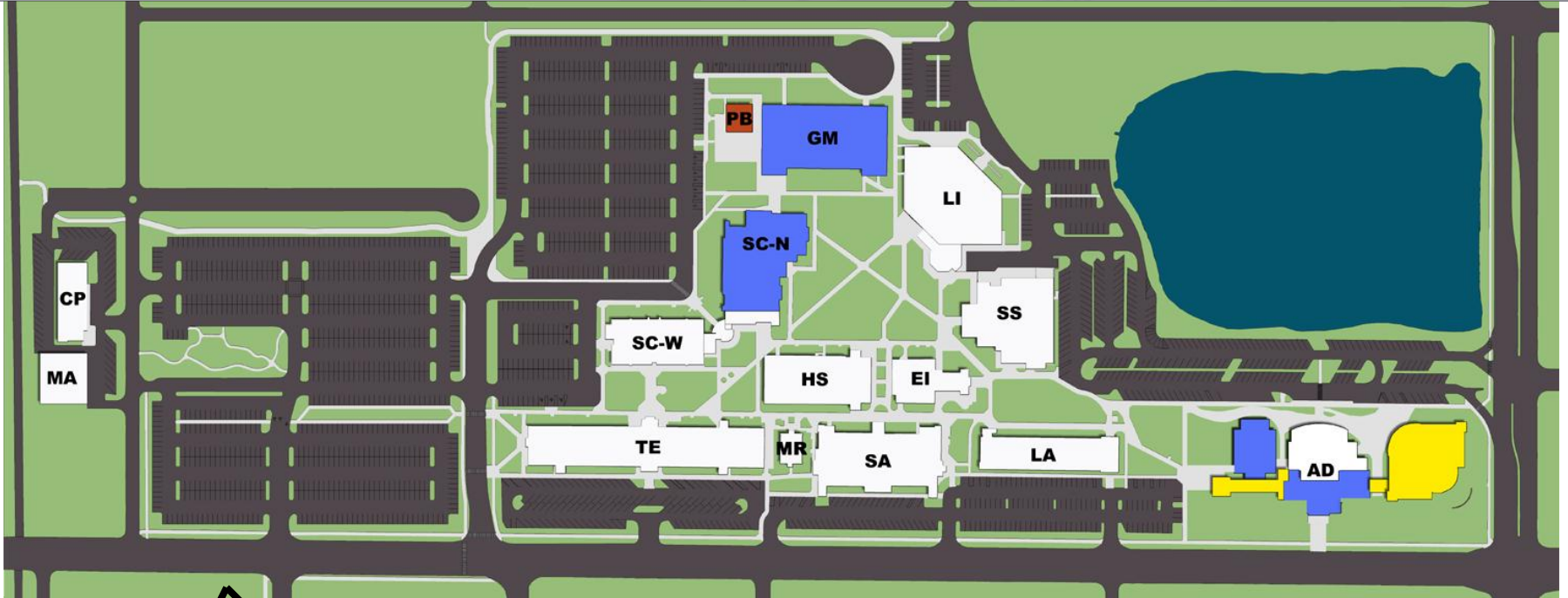

PHASE TWO

Item	Description
1	Renovation/Remodel of Natural Science – North (SC-N) Building

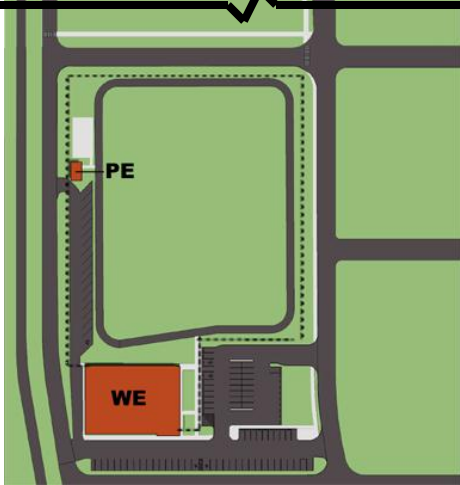

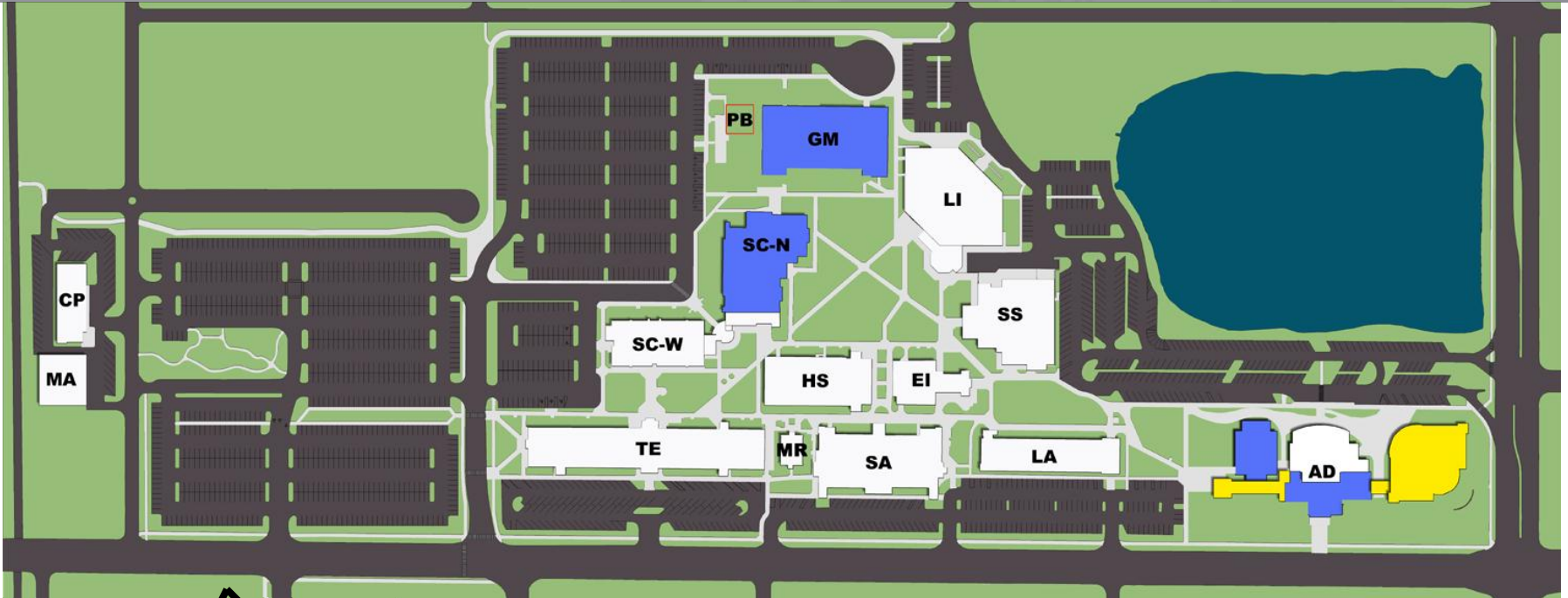

PHASE THREE

Item	Description
1	Demolition of Portable (PB) Building
2	Remodel Gymnasium (GM)
3	Add Wellness Center to existing Gymnasium (40,000 gsf)



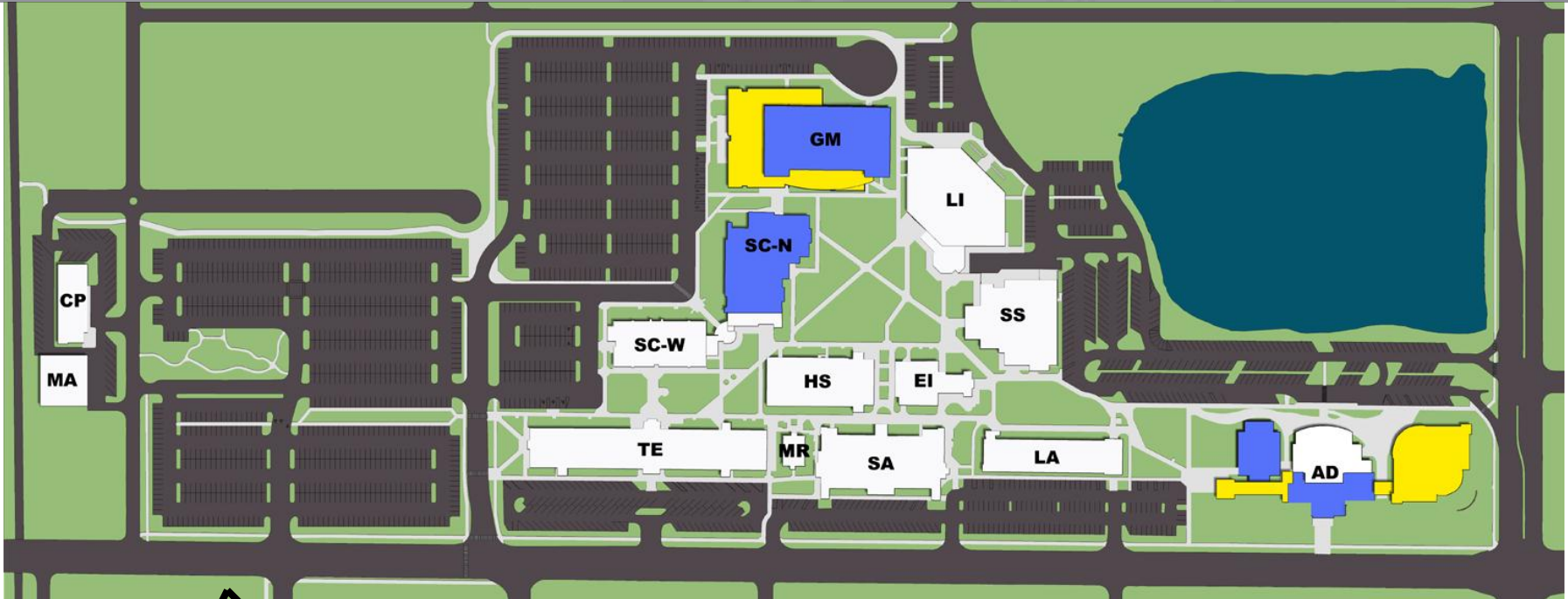

PHASE THREE

Item	Description
1	Demolition of Portable (PB) Building
2	Remodel Gymnasium (GM)
3	Add Wellness Center to existing Gymnasium (40,000 gsf)



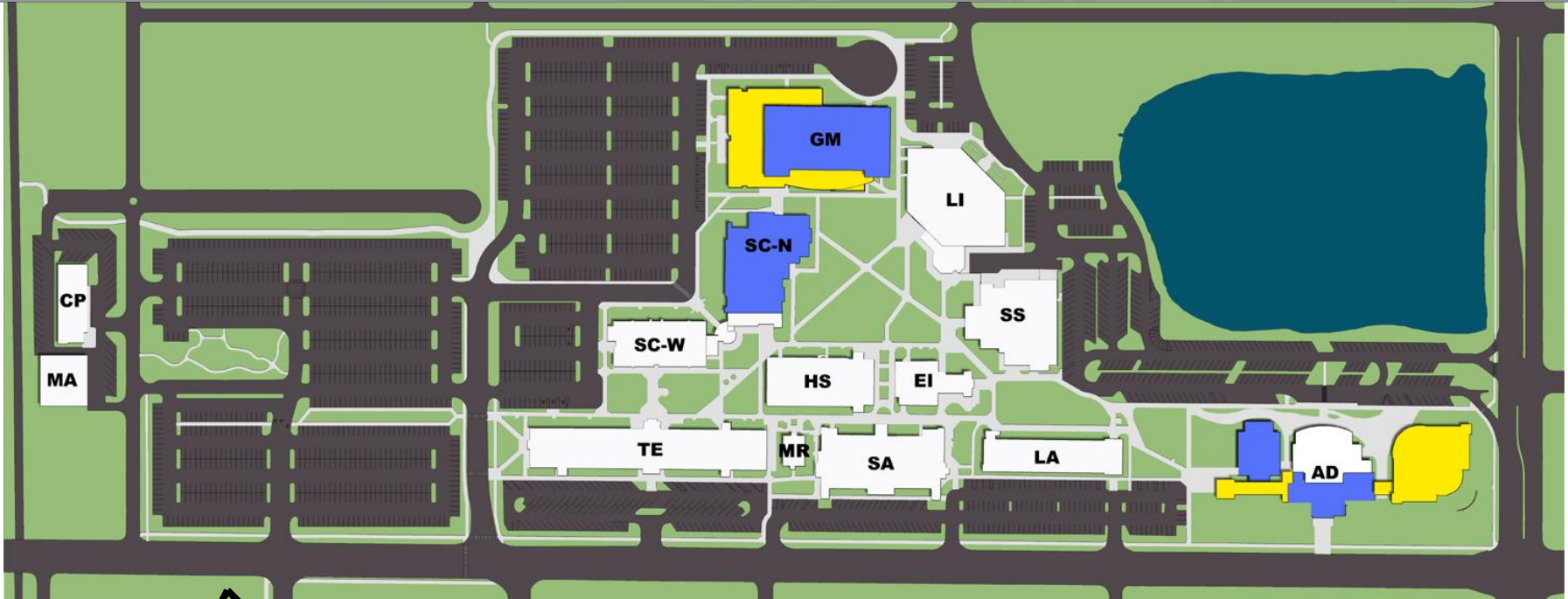

PHASE FOUR

Item	Description
1	Demolition Existing Wellness Center (WE)
2	Demolition of PE Building
3	Build New Academic Building at current wellness site (50,000gsf)



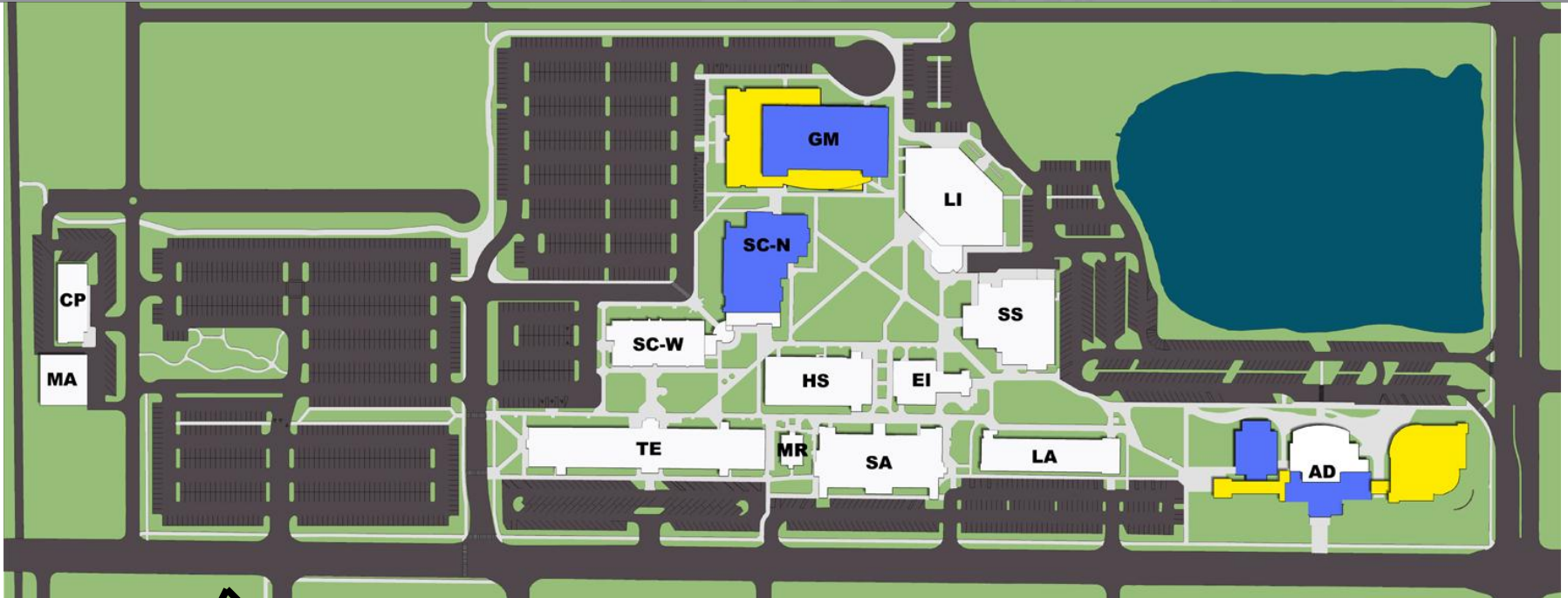

PHASE FOUR

Item	Description
1	Demolition Existing Wellness Center (WE)
2	Demolition of PE Building
3	Build New Academic Building at current wellness site (50,000gsf)





Square Footage Summary



Total Existing Square Footage of Campus:	476,083	
Total Square Footage to be Demolished:	- 54,799	
Existing Square Footage Remaining:		421,284 gsf
New Buildings to be Constructed in the Future		
Student Support Services Building	50,000	
Wellness Center Addition to Existing Gymnasium	40,000	
New Academic Building on Existing Wellness Site	+ 50,000	
Total		140,000 gsf
New Grand Total		561,284 gsf
Total SF Gained based on Master Plan Build out (140,000 - 54,799)		85,201 gsf

Collegewide Masterplanning St. Petersburg/Gibbs Campus

Master Plan 3D View

	New Construction
	Renovated/Remodeled
	Existing Buildings



	New Construction
	Renovated/Remodeled
	Existing Buildings





Student Services Building
Brick Details & Painted Stucco



Natural Science Building
Blue Metal Roofs



W. Richard Johnston Technical Building
Brick Detail & Glass



West St. Petersburg Community Library
Brick Detail & Painted Stucco



Humanities Building Entry
Blue Metal Roof & Contemporary Collegiate Gothic Detail



W. Richard Johnston Technical Building Entry
Red Brick & Painted Stucco



Philip Benjamin Social Arts Building
Red Brick, White Stucco & Blue Metal Roof



West St. Petersburg Community Library & Food Service
Red Brick, Painted Stucco & Blue Metal Roof

Outdoor Student Gathering Spaces



Students in Quad near the West St. Petersburg Community Library & Food Service



Central Quad Area Facing the Humanities Building

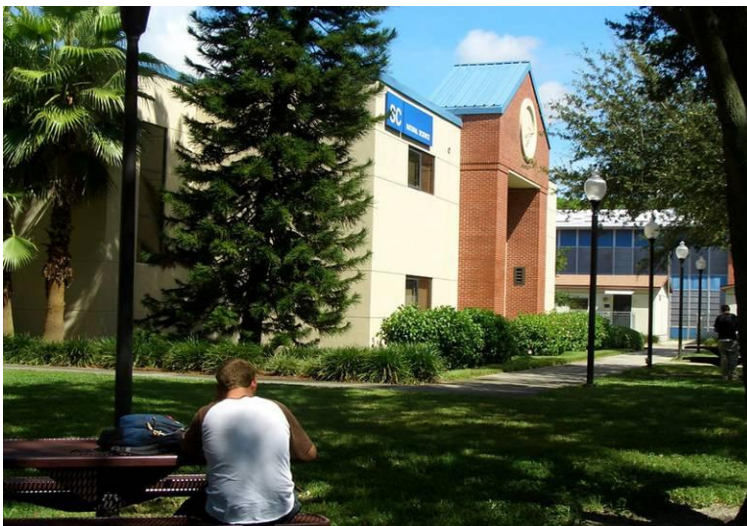

Student Studying in Quad Near the Natural Science Building



West St. Petersburg Community Library Entrance facing the Quad

Outdoor Student Gathering Spaces



Picnic Tables near the Natural Science Building



Outdoor Seating near the Ethics Institute Building



Students Gathering in between the Ethics Institute and the Humanities Building



Monumental Signs located throughout the campus



Electronic Signage located at the Quad



**Building Identification Sign Example
at the Student Services Building**



Directional Maps located throughout the campus

- **The campus is landlocked and has been built out.**
- **Much of the campus has been remodeled/ renovated or newly built over the past 20 years.**
- **There are expansion possibilities at the Gymnasium.**
- **The Board of Trustees has identified the Administration Building for renovation and replacement and the addition of a new Student Support Services building connected to the original Administration Building.**