

# Clearwater Campus

**Clearwater Campus**  
2465 Drew St.  
Clearwater



**KEY**

- ACCESS TO DISABLED PARKING
- DISABLED ACCESSIBLE DOORS

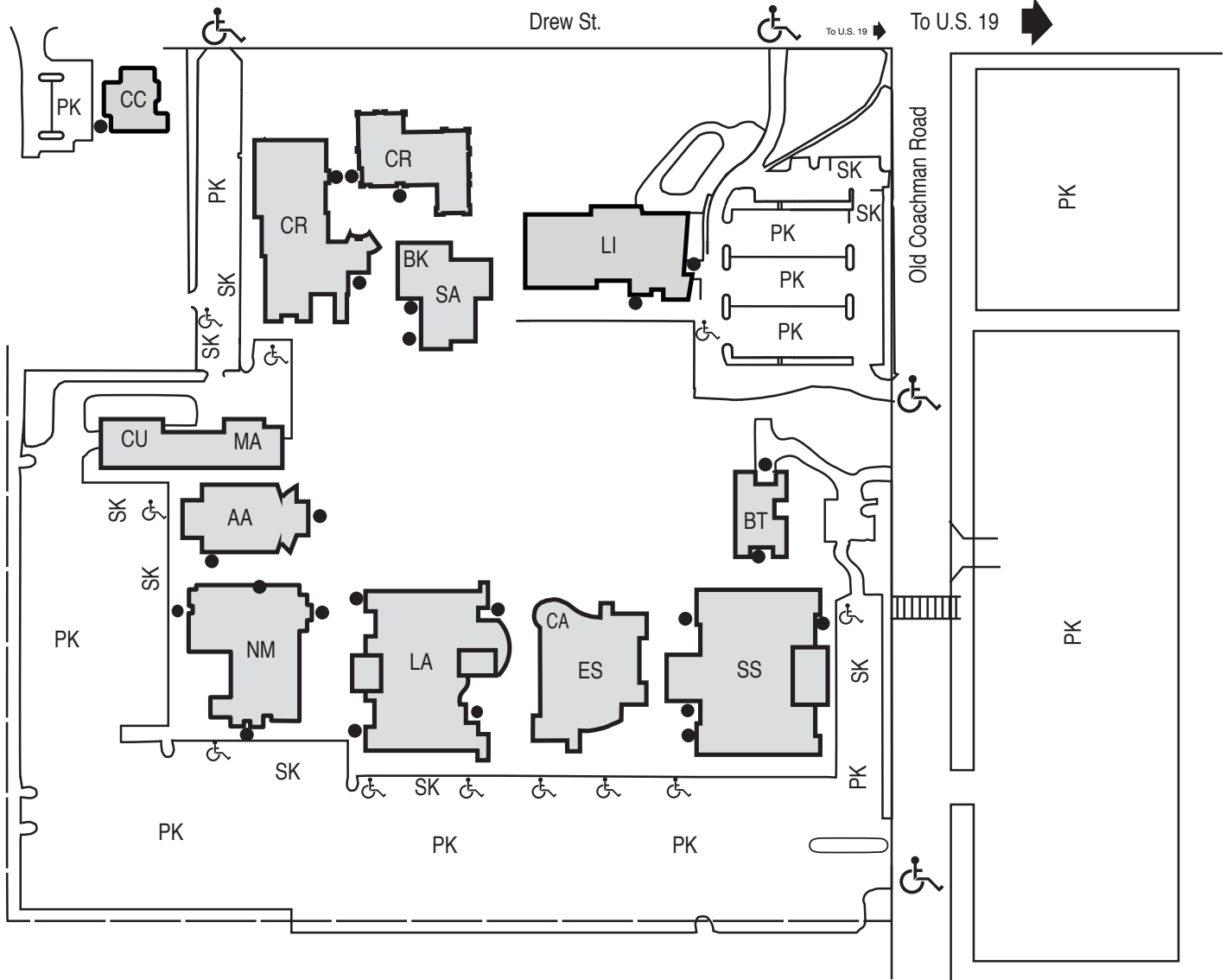

**CLEARWATER CAMPUS BUILDING CODES**

- |   |  |   |
|---|--|---|
| AA - Arts Auditorium                                | LA - Language Arts   | NM - Natural Science, Math and College of Education |
| BK - Bookstore                                      | • Admissions   | PK - Student parking                                |
| BT - Business Technologies                          | • Advising   | SS - Social Sciences                                |
| CA - Cafe/Food services                             | • Business Office  | SK - Staff parking                                  |
| CR - Crossroads                                     | • Financial Aid  | SA - Student Activities                             |
| CC - Collaborative Center for Emerging Technologies | • Testing  | • Bookstore   |
| CU - Central Utilities                              | LI - Michael M. Bennett Library and Learning Support Commons | • Student Life and Leadership                       |
| ES - Ethics and Social Sciences                     | MA - Maintenance   | • Wellness Center                                   |



# CLEARWATER CAMPUS

[Home](#) | [Friends Partners](#) | [About](#) | [Locations](#) | [Clearwater Campus](#)

## ABOUT SPC

- Allstate Center
- Bay Pines STEM Center
- Clearwater Campus**
- Downtown Center
- EpiCenter
- Health Education Center
- Midtown Center
- Seminole Campus
- St. Petersburg Gibbs Campus
- Tarpon Springs Campus
- Veterinary Technology Center
- Services by Campus
- Community Enrichment Facilities

## REGISTRATION HOURS

Monday - Thursday  
8:30 a.m. to 5:30 p.m.

Friday  
8:30 a.m. to 1 p.m.

## CLEARWATER CAMPUS CENTRALLY LOCATED IN PINELLAS COUNTY

Serving more than 14,000 students, the 40-acre [Clearwater Campus](#) opened in 1965 and is noted for its environmental-friendly facilities. This campus is home to:

- Collaborative Center for Emerging Technologies, a state-of-the-art training facility for advanced manufacturing
- Crossroads Gallery, where students and faculty regularly exhibit their works
- Theater program and productions
- Titan [baseball](#) and [softball](#) teams
- Three solar panel installations
- LEED (Leadership in Energy and Environmental Design) Gold Certified Natural Science, Mathematics and College of Education (NM) Building
- Visual arts facilities:
  - Photography labs, including a professional shooting studio, color processing area, 20-station digital studio, medium to large format industry-standard printers and private labs for students.
  - Ceramics facilities, including 20 professional Pacifica Gt-800 pottery wheels, Brent Sr-20 slab roller, Soldner Studio clay mixer, Peter Pugger VPM-60 pug/mixer, separate drying, glazing and mixing rooms, outdoor work area equipped two Raku kilns with adjacent firing pits, electric Skutt 1227PK kilns, 20 Cubic Food electric Bailey/Fredrickson computer-controlled front loading kiln, Geil DLB-40S computer-controlled kiln for gas firing and 20 cubic foot cross draft soda kiln.
  - Printmaking studio with Conrad etching press 28" x 40" and a smaller press 20" x 36", drying rack 36" x 48", vertical etching tanks, light exposure unit for photo silk screening, light table, clean paper room and an Apple computer.

## LOCATION

The St. Petersburg College Clearwater Campus is located at 2465 Drew Street, Clearwater, FL 33765.

Please note that some of our offices have moved as we continue to grow our campus:

Advising, Registration, Financial Aid, Business Office, Testing and the Associate Provost offices are now located in the Language Arts (LA) Building, Room LA100.

Career Services, Student Support Services (SSS Program), Learning Support Commons (Tutoring) and the Provost Office are now located in Second floor of the new library.



DOWNLOAD CLEARWATER CAMPUS MAP

### ACCESSIBILITY SERVICES

BLDG SS, ROOM 110 | [727-791-2710](tel:727-791-2710)

### BUSINESS OFFICE

BLDG LA, ROOM 100 | [727-791-5958](tel:727-791-5958)  
Includes paying for classes and student records.

### CAREER AND ACADEMIC ADVISING

BLDG LA, ROOM 100 | [727-791-2625](tel:727-791-2625)

### BOOKSTORE

BLDG ST, ROOM 108 | [727-431-4029](tel:727-431-4029)

### CAREER SERVICES

BLDG LI, ROOM 208 | [727-791-2622](tel:727-791-2622)

### EARLY COLLEGE AND DUAL ENROLLMENT

BLDG SS, ROOM 133 | [727-791-5977](tel:727-791-5977)

### FINANCIAL AID

[727-791-2485](tel:727-791-2485)

### FITNESS CENTER

BLDG ST, ROOM 104 | [727-341-4559](tel:727-341-4559)

### FOOD SERVICES

BLDG ES, ROOM 117 Hard Drive Cafe

### INTERNATIONAL PROGRAMS

BLDG LA, ROOM 190 | [727-791-2632](tel:727-791-2632)

### LEARNING RESOURCES

BLDG LI | [727-791-2674](tel:727-791-2674)  
Includes computer labs and writing studio.

### LOST AND FOUND

BLDG SS, ROOM 170

### PARKING

BLDG SS, ROOM 170 | [727-791-2506](tel:727-791-2506)

### SECURITY

BLDG SS, ROOM 170 | [727-791-2506](tel:727-791-2506)

### STUDENT ID

Library Reference Desk | [727-791-2614](tel:727-791-2614)

### STUDENT LIFE AND LEADERSHIP

BDLG ST, ROOM 130 | [727-791-2623](tel:727-791-2623)

### STUDENT LOUNGE

BLDG ST, ROOMS 113 | [727-791-2738](tel:727-791-2738)

### TESTING

BLDG LA, ROOM 103 | [727-791-2645](tel:727-791-2645)

### VETERANS SERVICES

BLDG SS, ROOM 102 | [727-791-2677](tel:727-791-2677)

### WOMEN ON THE WAY

[727-791-2533](tel:727-791-2533)